

# MODEL 106-GE / 206-GE GROOVED ENDS

## KEY FEATURES

- Convenient system and equipment access for ease of alignment and installation
- Improved flexibility with expansion, contraction and deflection
- Seismic stress absorption
- Eliminates unions



## PRODUCT OVERVIEW

For use with grooved Iron Pipe Size (IPS) Pipe Coupling Products, grooved ends allows you to benefit from the simplicity and convenience of grooved end piping and fittings in an automatic control valve. There are a wide range of applications where grooved ends are relevant, but typical applications include municipal water, waste water, fire protection and plumbing.

Grooved ends come in the following size ranges:

- 2 in / 50 mm – 8 in / 200 mm
- Angle ranges from 2 in / 50 mm – 3 in / 80 mm

Standard cut groove specifications for steel and other IPS pipe will apply, unless otherwise specified

VALVE DATA (US UNITS)

	DWG	Standard	Flat Diaphragm System						
Inches	REF	Grooved Ends	2 in	2-1/2 in	3 in	4 in	6 in	8 in	8 in (206)
<b>Globe Dimensions</b>			<b>All figures shown in inches unless otherwise stated</b>						
Lay Length	A		9.38	11.63	13.25	15.00	20.00	25.38	26.00
Centerline to Bottom	D		2.75	3.25	3.68	4.00	5.60	7.50	4.63
<b>Common Dimensions (Globe)</b>									
Width	C		6.00	8.19	9.25	10.88	16.75	21.63	16.00
Height (To Stem Cap) Globe	E		4.75	7.50	8.00	9.15	11.75	14.91	14.13
Body Port Tapping		FNPT	3/8	3/8	3/8	3/8	3/8	1/2	3/8
Stem Cap Plug		MNPT	3/8	3/8	3/8	3/8	3/8	3/8	3/8
Cover Port Tapping		FNPT	3/8	3/8	3/8	3/8	3/8	1/2	1/2
Valve Stroke			9/16	15/16	1 1/8	1 7/16	1 11/16	2 7/8	1 11/16
Displaced Bonnet Volume (Gallons)			0.02	0.07	0.1	0.2	0.6	1.7	0.6
Approximate Shipping Weight (Lbs)			40	65	100	175	400	650	500
<b>Flow Capacities (USGPM) Globe</b>									
$C_v$			55	80	110	200	460	800	505
Continuous (Globe)			210	300	460	800	1800	3100	2300
Intermittent (Globe)			260	375	575	1000	2250	3875	2700
Momentary (Globe)			470	670	1030	1800	4000	7000	4800
<b>Maximum Pressure Ratings (Ductile Only)</b>									
PSI <sup>1</sup>		Grooved Ends	400	400	400	400	400	400	400
<b>Maximum Temperature</b>									
Fahrenheit			180°	180°	180°	180°	180°	180°	180°

<sup>1</sup>Valves rated and stamped 400 psi as standard. Valves rated and stamped 600 psi on request.

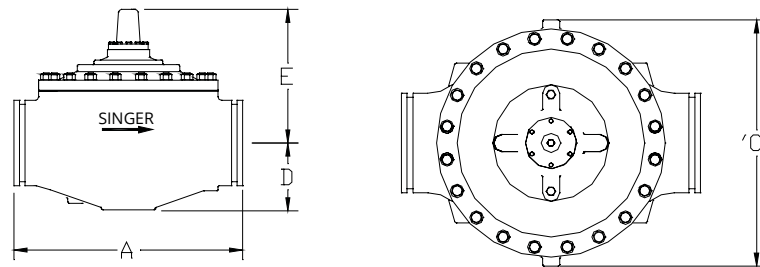

# MODEL 106-GE / 206-GE GROOVED ENDS

## VALVE DATA (METRIC UNITS)

MM	DWG	Standard	Flat Diaphragm System						
	REF	Grooved Ends	50 mm	65 mm	80 mm	100 mm	150 mm	200 mm	200 mm (206)
<b>Globe Dimensions</b>			<b>All figures shown in millimeters unless otherwise stated</b>						
Lay Length	A		238	295	337	381	508	645	660
Centerline to Bottom	D		70	83	93	102	142	191	118
<b>Common Dimensions (Globe)</b>									
Width	C		152	208	235	276	425	549	406
Height (To Stem Cap) Globe	E		121	191	203	232	298	379	359
Body Port Tapping	FNPT	Inches	3/8	3/8	3/8	3/8	3/8	1/2	3/8
Stem Cap Plug	MNPT	Inches	3/8	3/8	3/8	3/8	3/8	3/8	3/8
Cover Port Tapping	FNPT	Inches	3/8	3/8	3/8	3/8	3/8	1/2	1/2
Valve Stroke		mm	14	25	29	37	43	73	43
Displaced Bonnet Volume (Litres)			0.1	0.3	0.3	0.8	2.1	6.3	2.1
Approximate Shipping Weight (Kilograms)			18	29	45	79	181	295	227
<b>Flow Capacities (L/s) Globe</b>									
$K_v$ (Globe)			13	19	26	47	110	190	120
Continuous (Globe)			13	19	29	50	114	196	145
Intermittent (Globe)			16	24	36	63	142	244	170
Momentary (Globe)			30	42	65	114	252	442	300
<b>Maximum Pressure Ratings (Ductile Only)</b>									
Bar <sup>1</sup>		Grooved Ends	27.6	27.6	27.6	27.6	27.6	27.6	27.6
<b>Maximum Temperature</b>									
Celsius			82°	82°	82°	82°	82°	82°	82°

<sup>1</sup>Valves rated and stamped 27.6 Bar as standard. Valves rated and stamped 41 Bar on request.

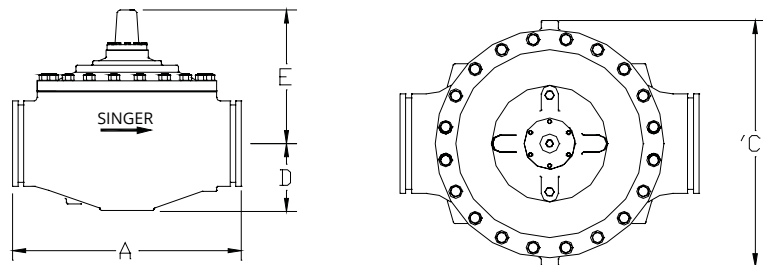

## ORDERING INSTRUCTIONS

Refer to page 244 for the order form and ordering instructions.